

Soils Map - 49.23 Acres

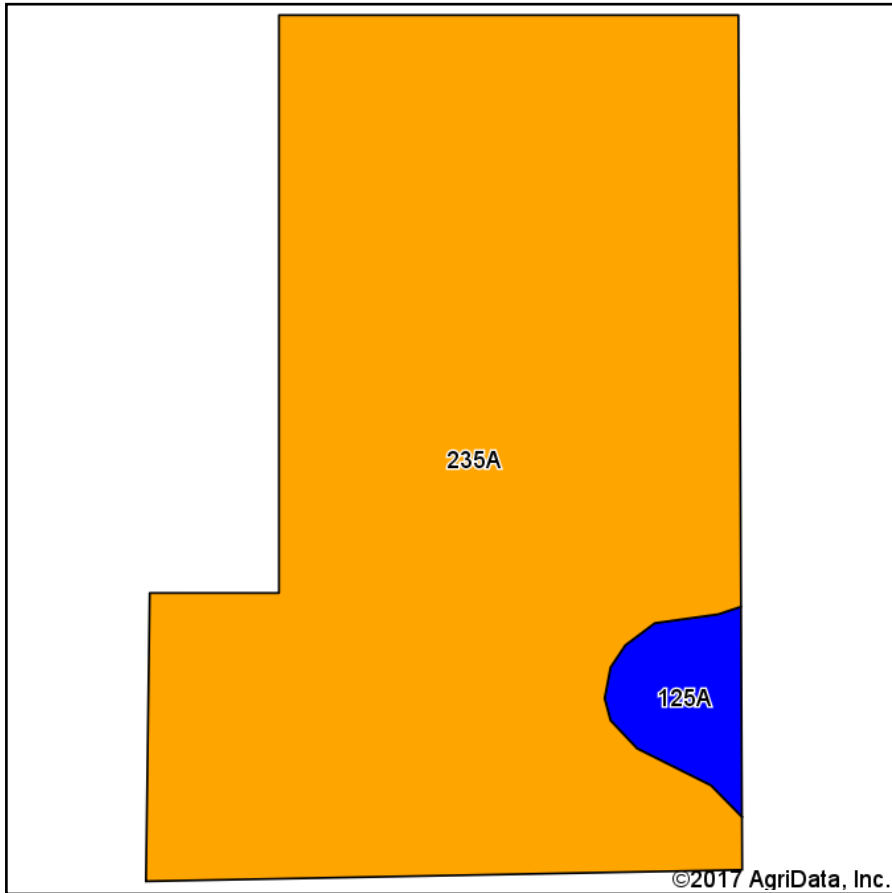

Soils data provided by USDA and NRCS.

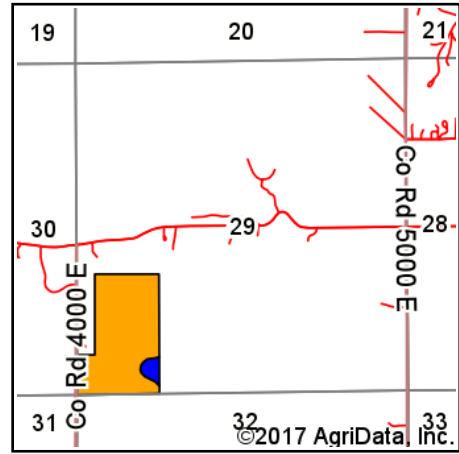

State: **Illinois**
 County: **Grundy**
 Location: **29-33N-8E**
 Township: **Goose Lake**
 Acres: **49.23**
 Date: **2/28/2017**

RO
 RICHARD A. OLSON
 & ASSOCIATES, INC.
 531 W. Bedford Road, Morris, IL 60450
 Ph: 815-942-4269 Fx: 815-942-4654
 www.richardaolson.com

Maps Provided By:

 CUSTOMIZED ONLINE MAPPING
 © AgriData, Inc. 2017 www.AgriDataInc.com



Area Symbol: IL063, Soil Area Version: 11

Code	Soil Description	Acres	Percent of field	Il. State Productivity Index Legend	Corn Bu/A	Soybeans Bu/A	Wheat Bu/A	Crop productivity index for optimum management
235A	Bryce silty clay, 0 to 2 percent slopes	47.08	95.6%		162	54	64	121
125A	Selma loam, 0 to 2 percent slopes	2.15	4.4%		176	57	70	129
Weighted Average					162.6	54.1	64.3	121.3

Area Symbol: IL063, Soil Area Version: 11

Table: Optimum Crop Productivity Ratings for Illinois Soil by K.R. Olson and J.M. Lang, Office of Research, ACES, University of Illinois at Champaign-Urbana. Version: 1/2/2012 Amended Table S2 B811

Crop yields and productivity indices for optimum management (B811) are maintained at the following NRES web site:

<https://www.ideals.illinois.edu/handle/2142/1027/>

** Indexes adjusted for slope and erosion according to Bulletin 811 Table S3

Soils data provided by USDA and NRCS. Soils data provided by University of Illinois at Champaign-Urbana.

*c: Using Capabilities Class Dominant Condition Aggregation Method