

Tract 2 - 35 Acres - Soils Map

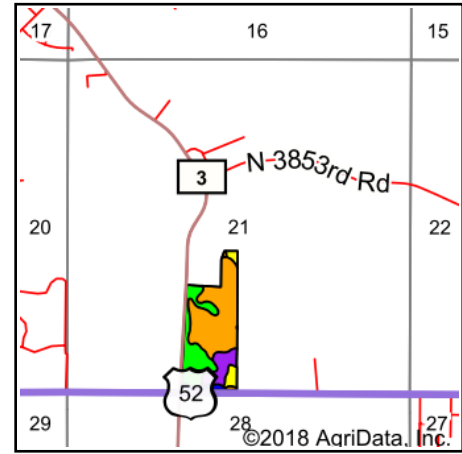
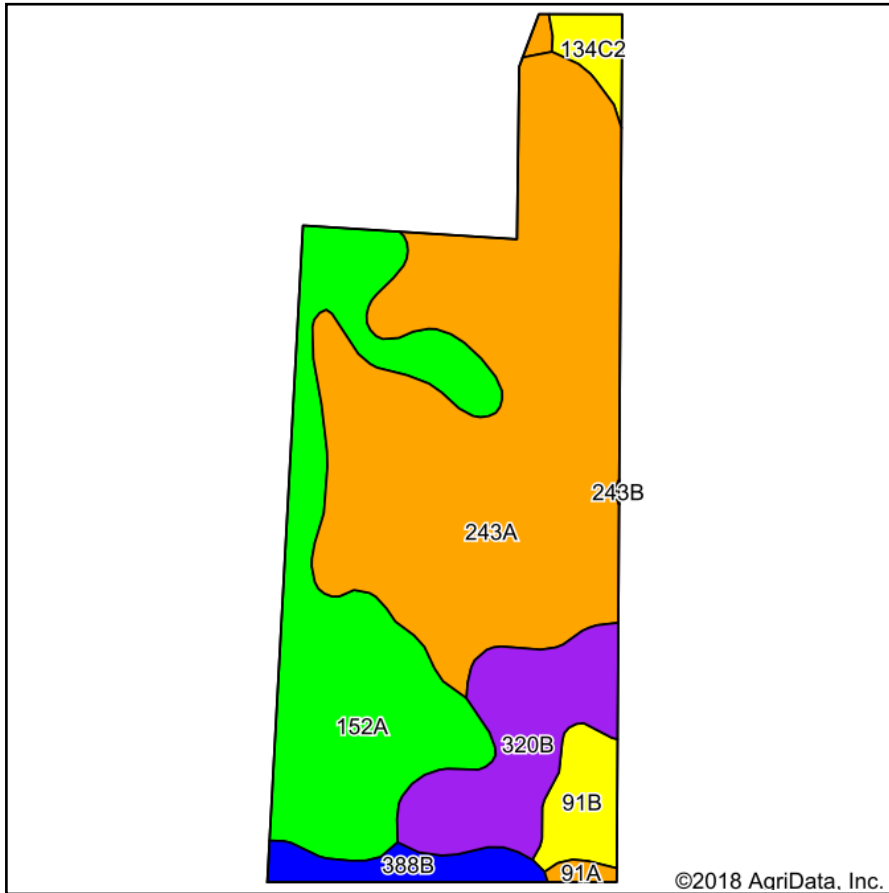

State: **Illinois**
 County: **La Salle**
 Location: **21-35N-5E**
 Township: **Mission**
 Acres: **35**
 Date: **10/16/2018**

RO
 RICHARD A. OLSON
 & ASSOCIATES, INC.
 531 W. Bedford Road, Morris, IL 60450
 Ph: 815-942-4269 Fax: 815-942-4654
 www.richardaolson.com

Maps Provided By:

 CUSTOMIZED ONLINE MAPPING
 © AgriData, Inc. 2018 www.AgriDataInc.com



Soils data provided by USDA and NRCS.

©2018 AgriData, Inc.

Area Symbol: IL099, Soil Area Version: 14

Code	Soil Description	Acres	Percent of field	Il. State Productivity Index Legend	Corn Bu/A	Soybeans Bu/A	Wheat Bu/A	Crop productivity index for optimum management
243A	St. Charles silt loam, 0 to 2 percent slopes	18.15	51.9%		168		52 65	122
152A	Drummer silty clay loam, 0 to 2 percent slopes	9.37	26.8%		195		63 73	144
**320B	Frankfort silt loam, 2 to 4 percent slopes	3.98	11.4%		**133	**46	**57	**100
**91B	Swygert silty clay loam, 2 to 4 percent slopes	1.34	3.8%		**156	**51	**62	**117
**388B	Wenona silt loam, 2 to 5 percent slopes	1.20	3.4%		**171	**55	**67	**128
**134C2	Camden silt loam, 5 to 10 percent slopes, eroded	0.64	1.8%		**154	**47	**60	**111
91A	Swygert silty clay loam, 0 to 2 percent slopes	0.19	0.5%		158		52 63	118
**243B	St. Charles silt loam, 2 to 5 percent slopes	0.13	0.4%		**166	**51	**64	**121
Weighted Average					170.6	54.2	66.1	125.2

Table: Optimum Crop Productivity Ratings for Illinois Soil by K.R. Olson and J.M. Lang, Office of Research, ACES, University of Illinois at Champaign-Urbana. Version: 1/2/2012 Amended Table S2 B811

Crop yields and productivity indices for optimum management (B811) are maintained at the following NRES web site: <http://soilproductivity.nres.illinois.edu/>

** Indexes adjusted for slope and erosion according to Bulletin 811 Table S3

Soils data provided by USDA and NRCS. Soils data provided by University of Illinois at Champaign-Urbana.

*c: Using Capabilities Class Dominant Condition Aggregation Method